

ENGWALD DOOR OR WALL UNIT

MODEL - X-100-G

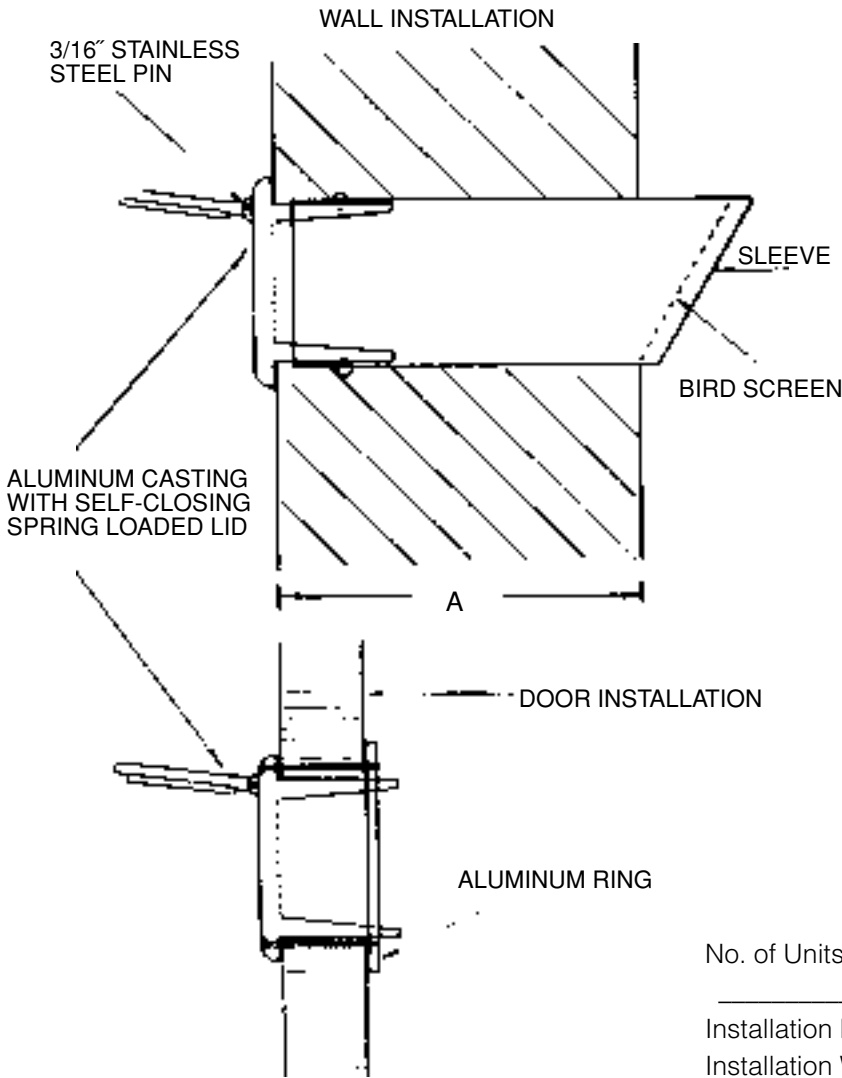

UNITS ARE AVAILABLE FOR HOSE SIZES
IN 3"-4"-5"-6" X-100-G- (NUMBER HERE)
INDICATES LARGEST HOSE SIZE THAT
CAN BE USED WITH UNIT

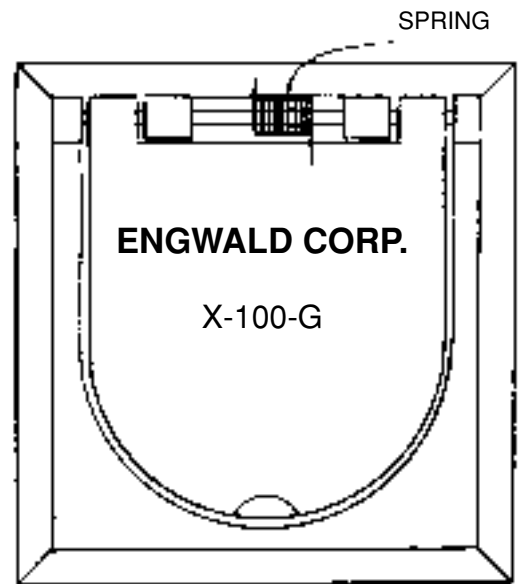

No. of Units: _____
 Installation Door: _____
 Installation Wall: _____
 Wall Thickness/ Dimension "A": _____

Job Name: _____

Contractor: _____

Remarks: _____

Wall Sleeve Galvanized: _____

Wall Sleeve Aluminum: _____

Wall Sleeve Stainless Steel: _____

Hose Assemblies If Required

Neoprene: _____ = _____ X

Galvanized: _____ = _____ X

Stainless Steel: _____ = _____ X

